



safety certified
ECE R44/04



KEEP FOR FUTURE REFERENCE

phil&teds®
alpha™



protect™

The alpha™ complies with requirements applicable in market of sale

For rights & remedies, refer www.philanteds.com/warranty

Please register your purchase through our online warranty registration by visiting: www.philanteds.com/register



philanteds.com

The protect™ complies with requirements applicable in market of sale

For rights & remedies, refer www.mountainbuggy.com/warranty

Please register your product purchase through our online warranty registration by visiting: www.mountainbuggy.com/register



mountainbuggy.com

Congratulations on choosing your new child seat!



Product Care



Safety Warnings



Features



Instructions



GENERAL INSTRUCTIONS

Group 0+

Suitable for birth to 13kg child.

**THIS DOCUMENT CONTAINS
IMPORTANT INFORMATION AND MUST
BE KEPT WITH THE SEAT FOR FUTURE
REFERENCE.**

This product should be used rearward facing until the child is too large for the seat or exceeds 13kgs.

This product should never be used forward facing.

CLEANING & CARING

Check your car seat for cuts & bruises. If your product is damaged in any way, or you're not sure how to use it, please consult our web support from where you can access a local customer care team.

Caring for your car seat

Unlike children, your car seat likes to stay clean.

Cleaning the fabric cover:

- Read the label on the removable cover for washing instructions.
- Hand wash in warm water only.
- DO NOT tumble dry.
- The fabric cover can be easily removed for washing.
 1. Remove the harness by gently feeding it through from the front to the back of the seat.
 2. Next remove the crotch strap, including buckle, by rotating it a quarter turn and feeding it out through the seat shell. The cover should now be free of obstruction.
 3. Remove the cover and hand wash it at 30°C; dry flat - away from direct heat.
 4. To replace the cover follow the instructions above in reverse.



Cleaning the harness, chest pads and seat:

- Sponge clean only. Use hand soap and warm water.
- DO NOT use solvents, harsh detergents or washing up liquids as these may weaken the harness and seat.
- Use only mild detergents.
- DO NOT lubricate or oil any part of the seat.
- DO NOT wring.
- Dry thoroughly before storage.
- Store in a well ventilated space, away from direct sunlight which could damage or fade your product.
- Store in a safe place when it is not being used. Avoid placing heavy objects on top of it.
- DO NOT allow to come into contact with corrosive substances e.g. battery acid.

Cleaning the buckle

Food, drink, or other debris may collect inside the harness buckle which can affect proper function. Wash in warm water until clean. Be sure you can hear an audible click to make sure the buckle is working properly.

The correct use and maintenance of your carseat will ensure it gives long and trouble free use. When somebody else is using your car seat, ensure that they also know how to use it and especially the correct way to adjust it. The safety of your child is your responsibility.

IMPORTANT

Please read thoroughly before commencing installation as an incorrect installation could be dangerous.

- This is a “Universal” child restraint; it is approved to ECE Regulation 44.04 for general use in vehicles and will fit most, but not all, vehicle seats.
- A correct fit is likely if the vehicle manufacturer has declared in the vehicle handbook that the vehicle is capable of accepting a “Universal” child restraint for this group.
- This child restraint has been declared “Universal” under more stringent conditions than those applied to earlier designs which do not carry this notice.
- If in doubt, consult either phil&teds/Mountain Buggy or the retailer.

Extreme Hazard

- Do not use in passenger seats equipped with airbags.



WARNINGS

- PLEASE READ THOROUGHLY BEFORE COMMENCING INSTALLATION AS AN INCORRECT INSTALLATION COULD BE DANGEROUS.
- THIS CHILD SEAT SHOULD NEVER BE USED ON A PASSENGER SEAT EQUIPPED WITH AN AIRBAG.
- The child seat must only be installed in a rear facing position.
- Important: Because of potential medical issues inherent in low birth weight and premature infants, always have a trained professional doctor, or hospital staff member assess the suitability of the child restraint prior to leaving the hospital or using the child restraint.
- Do not remove any labels on the child safety seat. Important information is contained on the labels.
- Do not modify the child safety seat in any way.
- Do not take apart or attempt to take apart or attempt to take apart the child safety seat except as instructed in this manual.
- Do not use the child safety seat with damaged or missing parts.
- Do not use damaged or frayed harness straps or vehicle belt.
- Never use this child safety seat without the car seat cover.
- Do not replace the child seat cover or harness with any other than the ones we recommend as these parts are integral to the child safety seat's performance.
- Never use this child restraint with any other base except ones that the manufacturer permits.
- Do not use a child safety seat that has been in a crash. A crash can cause damage to the child safety seat that you cannot see.



- Do not use a second-hand child seat or child seat whose history you don't know.
- Always check the tightness of the restraint and the harness before each use.
- Always make sure all vehicle belts and harness straps are not twisted before each use.
- Never leave the child in the child seat when the harness straps are loose or undone.
- Never leave your child unattended even for a short time.
- Do not leave your child in this restraint for an extended period of time.
- Do not use this child seat on a vehicle passenger seat fitted with an active airbag. Death or serious injury can occur.
- Always install the child safety seat in a rear-facing position.
- Never install the child safety seat forward-facing.
- Do not use on the vehicle seats that face the sides or rear of the vehicle. Use the child safety seat only on the vehicle seats that face forward. According to accident statistics, children are safer when properly restrained in the rear seating positions than in the front seating positions.
- Never use this child safety seat with 2 point vehicle belts.
- Do not use in any configuration not shown in the instructions.
- Do not use alternative routings not shown in these instructions.
- Make sure that the child safety seat does not become trapped by folding or moveable passenger seat or in the door of your car.
- Make sure all folding passenger seats are properly latched.
- Do make sure to properly secure any loose objects, such as luggage or books, in your car



Safety Warnings

as they may cause injuries in the event of an accident.

- This child restraint should be securely belted in the vehicle even when not in use. In a crash or sudden stop, an unsecured child safety seat may injure other occupants.
- All occupants of the vehicle should be correctly restrained. Unrestrained passengers may be thrown into other passengers and cause serious injury or death in a crash.
- Do not allow children to play with or adjust the child safety seat.
- Always make sure the handle is properly locked in the upright carrying position before carrying a child in the child seat.
- Never take a child out of the child safety seat when the vehicle is moving.
- Cover the child safety seat when left in the direct sunlight. Parts of a child safety seat may become too hot for the child's skin. Always

check surfaces before placing a child in the child's seat. Seat cover may fade in direct sunlight.

- Never place the car seat or infant carrier near the edge of an elevated surface or on a soft surface such as a seat cushion or mattress. The car seat of an infant carrier could fall off these surfaces and cause serious injury or death.
- Never use the child safety seat with a shopping cart.
- Make sure the lap strap of the harness is worn low down so that the infant pelvis is firmly engaged.



CHECKLIST BEFORE USE

Inspect

- Only use this car seat rear facing
- Child restraint free of damage

Verify Child within Weight and Size Range

- Weight between birth and 13kg
- Height 74cm or less (top of head 2cm or more below top of shell)

Secure Child Properly in Child Restraint

- Correct shoulder strap height (at or slightly below shoulders)
- Harness not twisted and low across hips
- Harness secure and tight

Install Child Restraint Rearward-facing in Safe Location in Vehicle

- Vehicle seats that face front of vehicle only
- Handle locked in specified position (6a)
- Child facing rear of vehicle
- Position with NO active airbag
- 3 point (shoulder/lap) belt used
- Seat belt not twisted
- Belt path followed
- Tight against vehicle seat



Safety Warnings

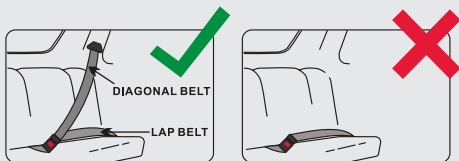

	On outer rear seat	YES
	On centre rear seat with 3-point belt	YES
	On a rearward-facing seat	NO
	On seats facing sideways	NO
	On rear seat with lapbelt only	NO
	Front seat with airbag off	YES



APPROVED SEAT BELT TYPES:

This car seat can only be fitted into the passenger seat of a car with a lap and diagonal seat belt and no air bag.

The car seat is only suitable if the vehicle is fitted with 3-point static or 3-point retractor safety belt, approved to UN/ECE Regulation No. 16 or other equivalent standards.

Do not use on a passenger seat with an airbag.





Features

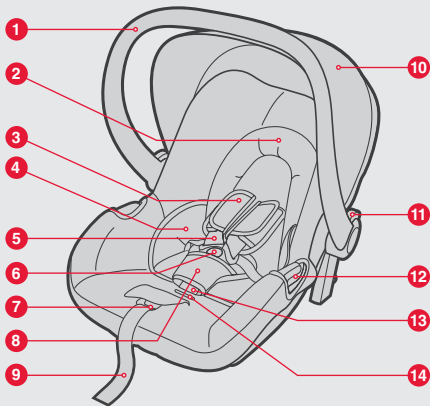

- 01 Handle
- 02 Head Support
- 03 Shoulder Pads
- 04 Infant Pads
- 05 Harness
- 06 Buckle
- 07 Adjuster Button
- 08 Crotch Pad
- 09 Adjuster Strap
- 10 Canopy
- 11 Handle Release Button
- 12 Lap Belt Guide
- 13 Crotch Belt
- 14 Crotch Strap Slot

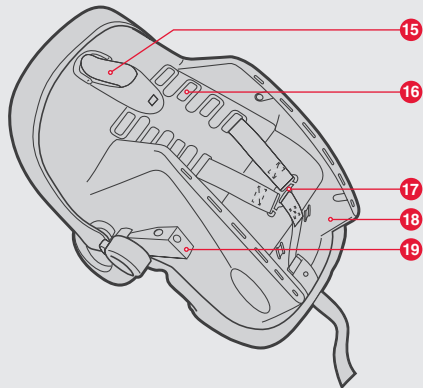

- 15 Shoulder Belt Guide
- 16 Harness Slot
- 17 Splitter Plate
- 18 Shell
- 19 Adapter* (only for some models)



Instructions

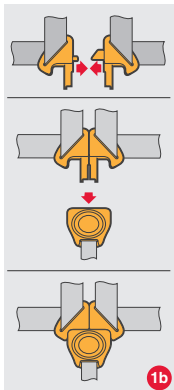

HARNESS POSITIONING

- 1a** Position the height of harness according to the child's height. The harness straps should be level with the child's shoulders. Do not use the child restraint with the harness if the child's shoulders are above the highest slots in the backrest or if the child's weight exceeds 13kg.

- 1b** Put the two buckle clips together, then lock into the female buckle. (1b)

Tighten the straps until they are in contact with your child's body.

CAUTION!

The hip belt must lie as low as possible over your child's hips.

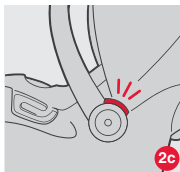
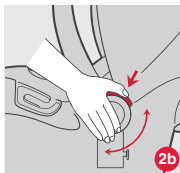
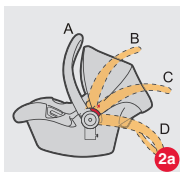

ADJUSTING THE HANDLE

- 2a** There are 4 positions: In vehicle position (A), Carry position (A), Middle position (B,C), and Stationary position(D)
- 2b** To adjust, squeeze handle release buttons on both sides, then rotate the handle, The handle will lock into position.
- 2c** You should hear a click when the handle button is engaged and handle is locked into the upright carrying position.

WARNING:

Always make sure the handle is securely locked in the upright carrying position before carrying.



Instructions

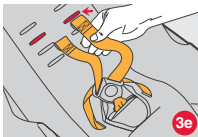
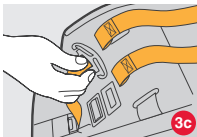
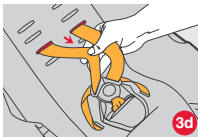
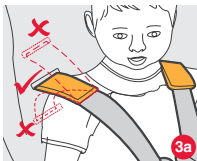

ADJUSTING THE HARNESS

- 3a Adjust the shoulder straps height so they are level with, or just below child shoulders.
- 3b To adjust the height of shoulder straps, you need to take out the straps from the splitter plate located in the rear of the seat.
- 3d Pull both straps through the shell and seat cover.
- 3e Thread the harness straps through the proper harness slot. Make sure that both straps are even and not twisted. From the rear of the seat, secure the harness strap onto the splitter plate (3b). Pull to make sure the harness straps are firmly secured onto the splitter plate. Remember, shoulder straps should be level with, or just below the child's shoulders (3a).

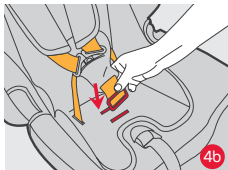
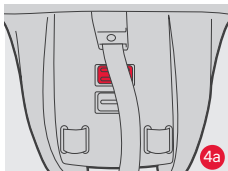

ADJUSTING THE CROTCH STRAP POSITION

The crotch strap adjusts to 2 positions to fit the child's size. Only move crotch strap position to outer position when the child weighs more than 7kg. Typically this is when the harness is in middle slots.

- 4a To move the crotch strap, locate the metal plate attached to the crotch strap under the child restraint (4a). Rotate the metal plate and push it through the shell and seat cover. Loosen harness adjuster strap if it is in the way.
- 4b Locate the appropriate crotch strap slot and insert the metal plate and crotch strap through the seat cover and shell (4b). Pull on harness buckle to make sure crotch strap is securely installed.

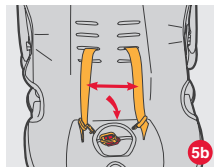
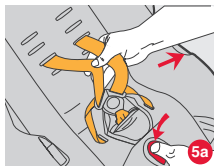

SECURING THE CHILD IN CHILD RESTRAINT

- 5a Press the adjuster button on the front center of the seat and pull on both shoulder straps to loosen the harness.
- 5b Press the red button on the buckle to release the shoulder straps and move them to the side.
- 5c Place child's bottom on the seat and the child's back flat against the back of the child restraint. This will increase the child's comfort and allow the harness to properly secure the child. Slide shoulder straps over the child's shoulders (5c). Make sure the harness is at or below the top of the child's shoulders.

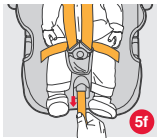
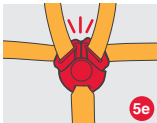
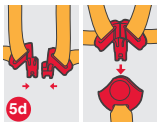

- 5d** Align the top and bottom buckle clips to form one clip.
- 5e** Insert into the buckle until you hear a “click!” Make sure the shoulder straps are not twisted. Adjust the shoulder pads over the centre of the child’s shoulders.
- 5f** Pull the harness adjustment strap until shoulder straps are tight against the child.
- 5g** For proper tightness, one finger should fit between the harness straps and the child’s shoulders.

To remove the child, loosen shoulder straps and release buckle.

Discontinue use when child’s weight is greater than 13kg, height is greater than 74cm or head is less than 2cm above the top of the shell.



APPROVED USES OUTSIDE OF THE VEHICLE

- ALWAYS secure the child with the harness when placing the child in the child restraint.
- ALWAYS make sure the handle is securely locked before using. For use as an infant carrier, place handle in carrying station (A in 2a). For rocking, place the child restraint on level ground, make sure handle is in carrier positions (A in 2a) and lock gently.
- For feeding and resting, place seat on secure and level surface away from the edge of elevated surfaces, and put handle in the stationary position (D in 2a).

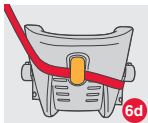
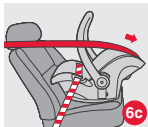
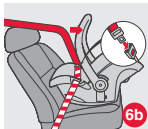

INSTALLATION IN THE VEHICLE WITHOUT BASE

- 6a Place the child restraint rear-facing on the vehicle seat and make sure the handle is in specified position. The child will face the rear of the vehicle.
- 6b Route the vehicle lap belt through both lap belt guides and buckle the seat belt.
- 6c Route the vehicle shoulder belt around the back of the child restraint and through the shoulder belt guide.
- 6d If vehicle shoulder belt is too short, please move vehicle seat as far back as possible and lower the vehicle seat height adjustment to the lowest possible height. If the vehicle belt is still too short, try another authorised seating position.



Instructions

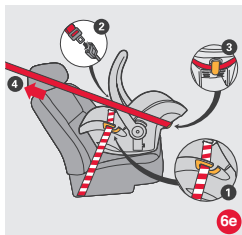

- 6e Adjust the child restraint to the proper recline to ensure maximum protection for the child. A tightly rolled towel under the front edge of the child restraint can be used to achieve the correct recline.

WARNING:

Do not route the vehicle belt using any other path when using the child seat. For assistance contact our Customer Service team.

Do not use 2 point vehicle belt to install this child seat. Only install the child restraint rear-facing on forward-facing vehicle seats.

Make sure the child is properly secured in the child restraint, and the child restraint is tightly installed in the vehicle.

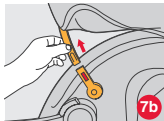
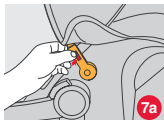

REMOVING THE CANOPY AND COVER

7a / 7b On the side of canopy, pull the tab and detach the canopy frame.

7c / 7d Pull out the cover from shell front.



TRAVEL SYSTEMS

This child seat can be used as a travel system in conjunction with selected strollers

Installing:

Having correctly attached an appropriate car seat adapter (sold separately) to your stroller, test that the child seat is fully attached by pulling the child seat up and forward; it should not come free from the car seat adaptor.

Removing the child seat:

Red release levers are located on both sides of the child seat, immediately above the connector points (as shown). Lift up on both levers then lift the child seat off the stroller using the carry handle.



alpha™



protect™



use only original mountain buggy or phil&teds car seat adapters to secure capsule to a buggy.

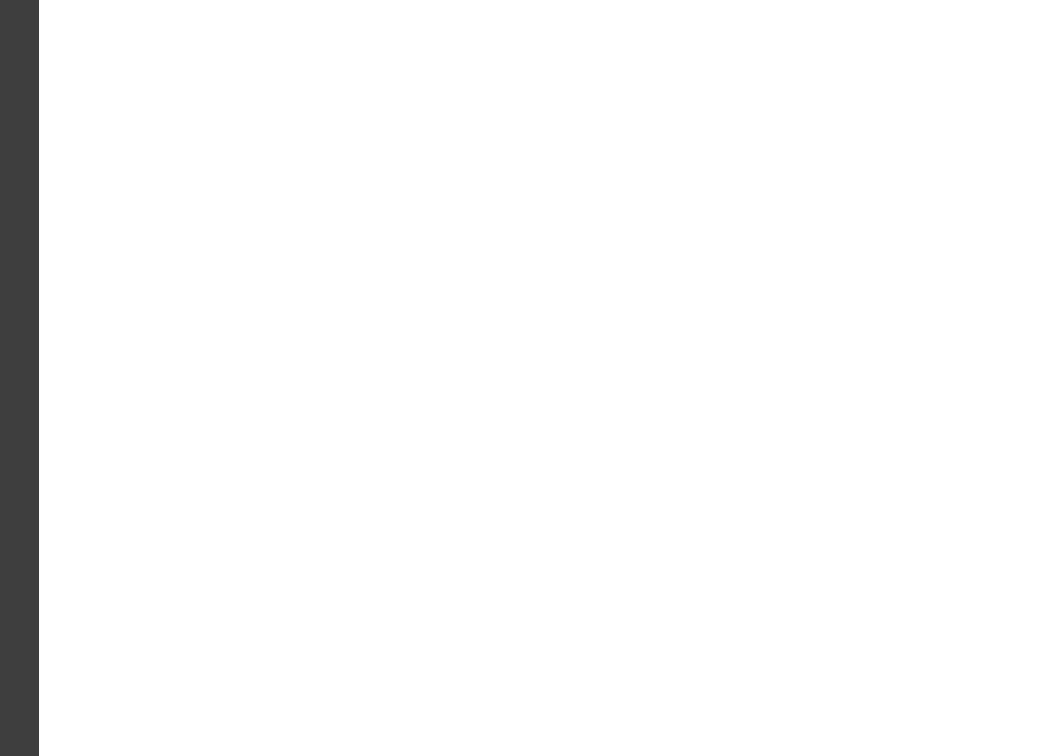

© Phil and Teds Most Excellent Buggy Company Ltd 2012.

We (Phil and Teds Most Excellent Buggy Company Ltd) own the intellectual property rights in our brands, designs and inventions featured in this publication. These include, without limitation, the phil&teds, adapt&survive!, &, INLINE trade marks and INLINE DOUBLE BUGGY shape. We actively pursue people who infringe our intellectual property.

©Phil & Teds Most Excellent Buggy Company Ltd 2012.

Nous (Phil and Teds Most Excellent Buggy Company Ltd) sommes détenteurs de tous les droits de propriété intellectuelle associés à nos marques, modèles et inventions mentionnés dans le présent document. Ceux-ci incluent, sans que cela soit limitatif, les marques commerciales phil&teds, adapt&survive !, &, et INLINE et la forme du INLINE DOUBLE BUGGY. Nous engageons des poursuites contre tous ceux qui enfreignent nos droits de notre propriété intellectuelle.

© Phil and Teds Most Excellent Buggy Company Ltd 2012.

Wir (Phil and Teds Most Excellent Buggy Company Ltd) sind Eigentümer aller geistigen Eigentumsrechte bezüglich unserer in dieser Veröffentlichung aufgeführten Marken, Designs und Erfindungen. Diese schließen die Marken phil&teds, adapt&survive!, &, und INLINE sowie die Form INLINE DOUBLE BUGGY ohne Einschränkungen ein. Personen, die unsere Eigentumsrechte verletzen, werden von uns aktiv verfolgt.

© Phil and Teds Most Excellent Buggy Company Ltd 2012.

Nos pertenecen a nosotros (Phil and Teds Most Excellent Buggy Company Ltd) los derechos de propiedad intelectual de nuestras marcas, diseños e inventos mostrados en la presente publicación. Se incluyen, sin limitarse a, las marcas phil&teds, adapt&survive!, &, e INLINE la forma de INLINE DOUBLE BUGGY. Iniciaremos acciones legales contra aquéllos que violen nuestra propiedad intelectual.

© Phil and Teds Most Excellent Buggy Company Ltd 2012.

Wij (Phil and Teds Most Excellent Buggy Company Ltd) bezitten de intellectuele eigendomsrechten op onze merken, ontwerpen en uitvindingen die in deze publicatie worden vermeld. Dit zijn, zonder beperking, de handelsmerken phil&teds, adapt&survive!, &, INLINE en de INLINE DOUBLE BUGGY-vorm. We dienen daadwerkelijk een aanklacht in tegen degenen die inbreuk maken op ons intellectueel eigendomsrecht.

AU/NZ

✉ Mountain Buggy Australasia
102-112 Daniell Street
Newtown, Wellington 6021
New Zealand / Nouvelle-Zélande.
☎ + 64 4 3800 833

EUR

✉ Mountain Buggy Europe
Klavermaten 37C
7472 DD Hof van Twente (Goor)
NETHERLANDS / Pays-Bas.
☎ + 31 (0) 547 352 727

USA/CAN

✉ Mountain Buggy USA
221 Jefferson Street
Fort Collins, CO 80524
USA.
☎ 1 800 916 8442

FRA

✉ Mountain Buggy France
15 rue Gertrude Bell
56000 Vannes
FRANCE.
☎ + 33 (0) 2 97 44 88 26
✉ france@mountainbuggy.com

Designed in New Zealand. Made in China
Conçu en Nouvelle-Zélande. Fabriqué en Chine
Conforme aux exigences de sécurité

AU/NZ

✉ phil&teds
102-112 Daniell Street
Newtown, Wellington 6021
New Zealand / Nouvelle-Zélande.
☎ + 64 4 3800 833

EUR

✉ phil&teds Europe BV
Klavermaten 37C
7472 DD Hof van Twente (Goor)
NETHERLANDS / Pays-Bas.
☎ + 31 (0) 547 352 727

USA/CAN

✉ phil&teds USA Inc
221 Jefferson Street
Fort Collins, CO 80524
USA.
☎ 1 800 839 4985

FRA

✉ phil&teds France
15 rue Gertrude Bell
56000 Vannes
FRANCE.
☎ + 33 (0) 2 97 44 88 26
✉ france@philandteds.com

Designed in New Zealand. Made in China
Conçu en Nouvelle-Zélande. Fabriqué en Chine
Conforme aux exigences de sécurité